

---

## Part XVI The Future is Now

**Author :** Meiliken

**Date :** 20-09-2019



No one knows for sure where the Future Holy Temple is to be built, but if the time were now, would not that be an important fact to know? Some say the Temple Mount is in the wrong place, that it is the wrong shape, or that the Temple and especially the Holy of Holies can be anywhere on the Mount and that there is no way to know. Usually whenever most everyone tells you one thing, like it being under the dome, we eventually find out they are all echoing one another, and truth is something else entirely. Would the Creator really have left something as important as this to chance? Would the Creator have properly concealed His treasure until its appropriate time or would He have entrusted it to Wikipedia?

For anyone that has not been following this series from its inception, you can find the [entire work here](#).

### **The Great Pyramid is Named After Someone and He's Not Egyptian**

Okay, to anyone not incentivized by tourism driven propaganda or cultural pride, the Great Pyramid at Giza could never seriously be considered Egyptian in origin, other than its obvious location. They never possessed the knowledge, nor technology to produce it. Nor did it ever contain or have an hieroglyphics, signs, statues, ornaments, or architecture typical of ancient Egypt. What it did contain was precision and information, precise information given to us in feet, inches, and mir cubits and how they interrelated with the pyramid's proportions and the mathematical constants of the universe.

Why **3** different measuring scales, or **3** different sets of scaling coordinates? One reason is that it makes it much easier to create and conceal advanced equations. Another is that you need to be familiar with all **3** systems in order to decipher it. The Egyptians could not. Nor could anyone utilizing the metric system, or anyone more than 30 years ago. Also, most of our Torah revelations are in **3**'s as in Triplets, **3** iterated Names, **3**-letter roots, cubes, and **3**-part Names. The Pyramid also contained a name, and not just any name. A Hebrew name, and not just any Hebrew name.

The height of the pyramid is **481.25** feet and its base is **756.25** feet, a different of exactly **275.00**, reflecting the value of the secret cubit, **27.5** inches. On the other hand, together (**481.25 + 756.25**) add up to **1237.5** feet. The Mir cubit is **27.5** inches. Since  $(1237.7 - 27.5) = 1210.0$  or

**1000 + 210**, it could be said to equal *Alef*(?) as **1000** plus the height of the Pyramid in levels and/or cubits, representing the **210** years of exile in Egypt. The equation also represents the sea of *Binah* (**1000**) pouring through the **4** rivers of Genesis **2:10** into the physical realm. The same equation can also be broken down into **1237.5 = (1100 + 110 + 27.5) = (40 cubits + 4 cubits + 1 cubit) = (? +? +?) cubits = (???) Adam**. The Pyramid is connected to Adam(???) , a 3-letter Name and the first name in the Torah other than G-d. **1237.5 = 45 cubits = Adam (???) = the aspect of the Tetragrammaton associated with *Zeir Anpin* and Man (Adam):**

## יוד־הא־וא־יהוּא

I do not know if we need to call it Adam's Pyramid, but it could also be called the Creator's. The Name (?????????????) also separates into **42 + (???)**, connecting us (Man) and the Pyramid to:

## I Am That I Am (אהיה־אשר־אהיה)

This is the Name the Creator gave to the Israelites in order to unlock their bonds to the physicality of Egypt. It was the Name of Awakening.

Part of the information conveyed to us in Adam's Pyramid was concealed in the capstone found at level **203**, as in the first **3** letters of the Torah (???) . The two first Names of G-d in the Torah, *Elohim* (?????) and *YHVH* (????) = **112**, matching the **112** Triplets. Alternatively, *YHVH* (????) + *Ehyeh* (????) + *Adonai* (????) = **112**. The combined Name *YHVH-Adonai* (????) = **91**. Together they sum to **(112 + 91) = 203**, meaning that the first **3** letters of the Torah contain **4** Names of G-d and connect to the **112** Triplets. It means the same for the **203** levels of the Pyramid.

The capstone measures **32.0833'** on each of the **4** bases and **20.4** feet high over its **7** levels. That height works out to **244.8** inches, as in the year **2448** when the Torah was received at Sinai and the Israelites left Egypt, and the base measure translates to exactly **14** cubits.

Before we move on to the purpose of bringing up the Pyramid yet again, please note that when we compare the capstone to the entire Pyramid its ratio of  $H_c$  to  $H_p$  and  $B_c$  to  $B_p$  is **4.24%**, making the capstone the ratio of *Moshiach Ben David* (**424**) in regards to the entire Adam Pyramid. I cannot imagine why the Egyptians would have done that.

It also means that the base of the capstone **244.8"**, as the year of Exodus (**2448 HC**) is **4.24%** (*Moshiach Ben David*) of Adam's Pyramid **5775"**, representing the last few years starting in **5775 HC** as **2448/5778** is also approximately **4.24%**. Adam (???) , as we have written about previously, is an acronym for Adam(?) David (?) *Moshiach* (?), and within the **5778**-year span from 0 – **5778**, the midpoint of King David's **70**-year life was in the year **2889 HC**, the midpoint from 0 – **5778 HC**. Adam(?) David (?) *Moshiach* (?).

Moreover, the difference from **2889 HC** to the year of Exodus (**2448 HC**) is

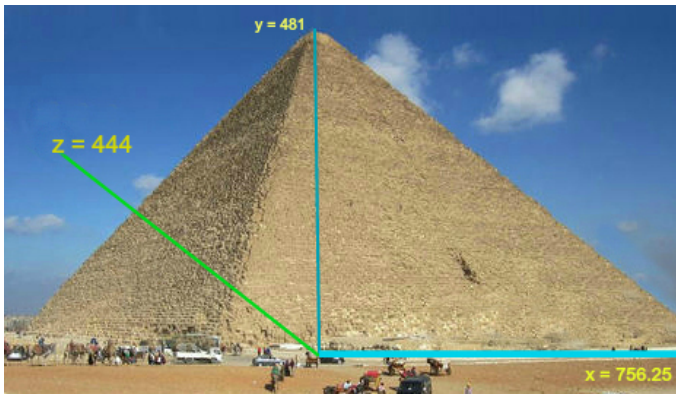

**441** years, the value of *Emet* (Truth). If you recall, we highlighted previously the tower of Truth within the Pyramid whereby **20** stacked cubes from 1 – **20** cubits per side equaled exactly **210** cubits in height and **44,100** cubic cubits in volume. Notably, the capstone is **20.4'** high. Again, these facts are meaningless if the Creator of the pyramid did not know both gematria and the future.

Did the Creator of the Pyramid know that the standard gematria of the word “*sefirot*” or dimensions (??????) is **756**, as in the **756'** base measurement of the Pyramid?

If the Creator of the pyramid did not know both gematria and the future, the numbers **244.8**, corresponding to **2448 HC**, and the number **441** as in **441** years later in 2889, and **66.6** jubilee years later in **5778 HC**, and the **4.24%**  $H_c$  to  $H_p$  ratio and the **6.66%**  $B_c$  to  $H_p$  ratio would be meaningless to employ, or to have invested 48 stories worth of quarried limestone and granite to preserve these measures for posterity.

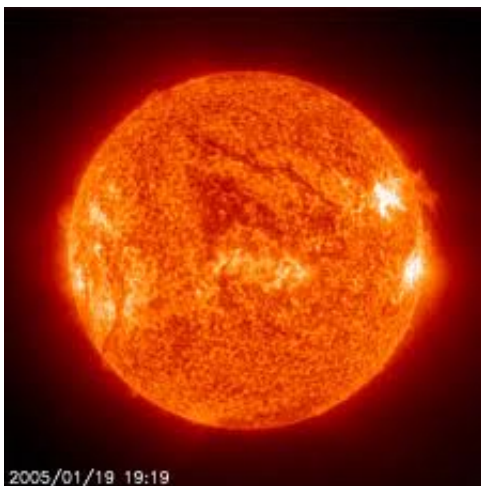

And while the Egyptians worshiped the Sun, it is highly doubtful they made the height of the capstone **244.8"** because the Solar rotation (sidereal) period of the Sun at its equator is about **24.48** days, or that they were trying to match the pyramid's height to the Sun's surface temperature of **5778° K**, 3300 plus years before the Kelvin scale was invented. That would have taken a more big picture Creator in terms of knowing the future and the dimensions of time and space.

We have asked why it was so important to safeguard the measure of the ancient cubit when no structure today is based on it? Well there is one that is still yet to be built and whose blueprints are given in cubits. As it turns out, that building/compound's location is predicated on that specific height measurement concealed from the ravishes of Man and time by the **244.8"** height of Adam's Pyramid's capstone, the pinnacle of truth.

The height of the exact location of the Holy of Holies of the Future Holy Temple is at an



elevation of **2448'** on the central Western edge of the Temple Mount, just as the Ramchal laid out for us. The elevations within the Temple Mount vary by over hundred feet, ranging from 2420 to 2520, yet **2448'** appears exactly where it should be. Of course, current structures on the Mount obscure more accurate surveys for more complete and precise dimensions.

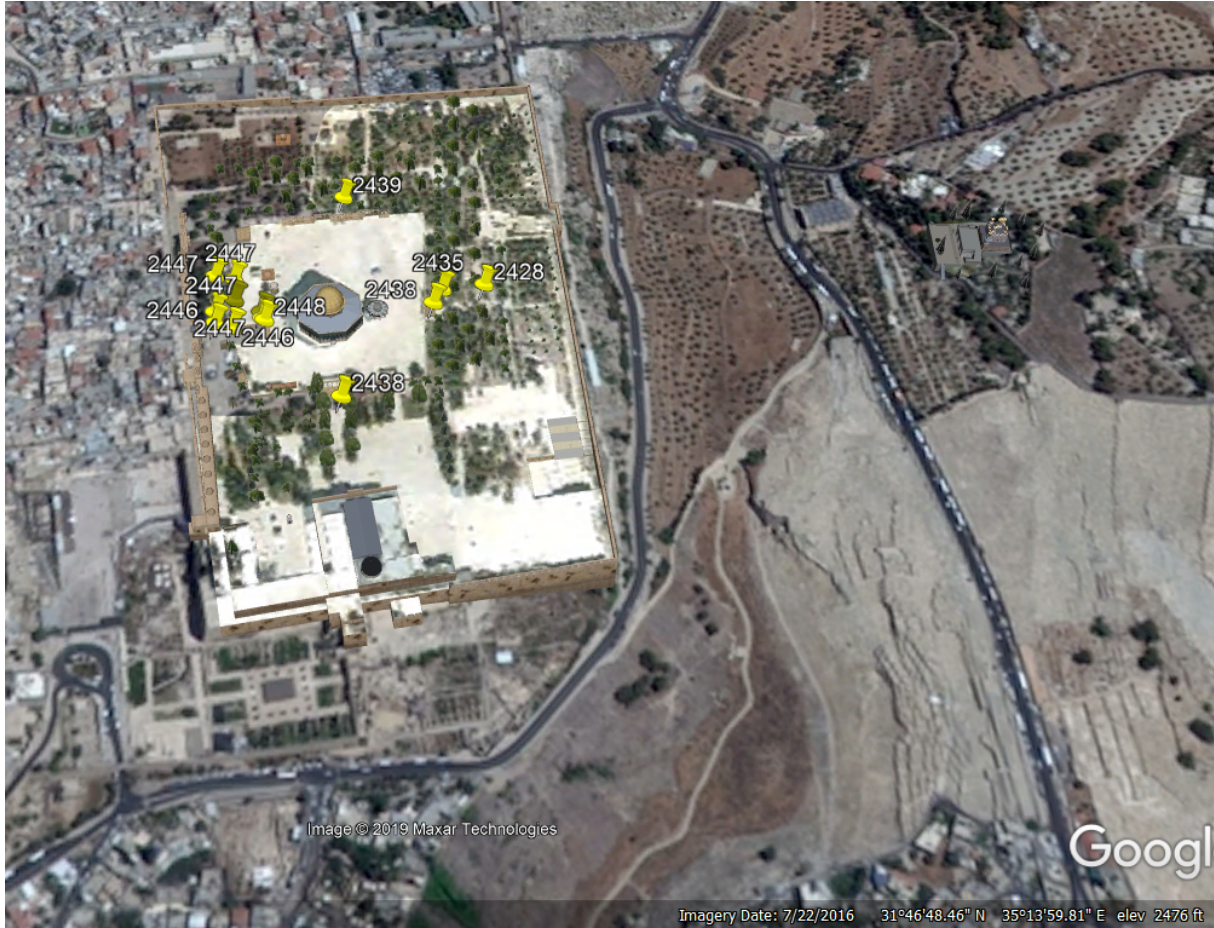



---

Let that sink in for a moment. This is critical information. We have been given the exact pinpoint location where to construct the Future Holy Temple. That is extremely practical detailed information. It is also mindboggling metaphysically. Never mind the **244.8'** height of the capstone, the year **2448** HC was the precise year we received the Torah and it matches up with the precise **2448'** location on the Temple Mount in Jerusalem, and thus with the corresponding **1313 BCE** date that the Hebrew *Alef-bet* was exponentially ( $1.313^x$ ) based on. It is from here that all the other information and all the other coordinates stem.

These located parameters on the Google Earth picture are approximate to within a few feet. Using the Ramchal's dimensions and locating the center of the Central Altar due East from there, we then marked off the edges of the Outer Courtyard using the cardinal directions. It is just a draft sketch and not an actual site plan.



The Temple Mount could have been at any other altitude. Or any other place. The place where it is located is at longitude E **35°14'02.27** and latitude N **31°46'33.59** and when added together they give us **66.603586°**. Let us restate clearly that the exact point of the Holy of Holies is found at the nexus point where the sum of the longitude and latitude meridians total **66.60358** degrees, or **66.6**, as in the **66.6** jubilee years from **2448** to today and **358**, the value of *Moshiach*. Yes, there are numerous places around the world and Mid-East where the meridians add up to **66.60**—that is just math—but nothing artificial made the specific altitude of **2448'** on

---

the Temple Mount line up with it exactly here.

**E 35°14'02.27**  
**N 31°46'33.59**  
**66.60'358 6°**

It is odd that we got here through the **244.8"** concealed height of the Pyramid's capstone with the height to base ratio of **66.60%**. Given the technology of the last few years, we could probably construct it to match the location of the Holy of Holies, but given the technology of ancient Egypt? That would have taken advanced knowledge, planning, and purpose. The point of the Pyramid points to the location of the Foundation Stone.

### **The Capstone Points to the Foundation Stone**

In the words of the Ramchal from *Mishkney Elyon*: "Understand that there is a special place known to her where all these roots come together....In the middle of that place where all these roots come together there is a single 'stone.' This stone is most precious....It is called the Foundation Stone (*Even Shetiyah ??? ?????*). There is a corresponding stone in this world—the lower world—in the place of the Holy of Holies."

The location of the Holy of Holies is also the precise spot where Abraham (**248**) was prepared to sacrifice Isaac (**208**). That was in **2085 HC**, **363** years before **2448 HC** with **363** being the numerical value of *H'Moshiach*. Of course, the Torah tells us that Abraham did not just happen upon that spot or that date, but was guided by the Creator. Moreover, not only is **756 x 481 = 363636**, but the perimeter of Adam's pyramid is **36,300"**, and using the cubit scale the perimeter is **330<sup>2</sup>/3 = 36,300** as well.



As for mountains, we know that the highest point on Earth is Mt Chimaborazo at **35,828** ft and the most famous and highest mountain, Everest is currently at about 29,029 ft. If we were to take the entire Pyramid as a capstone to a much larger pyramid using the same ratios of **4.24%** and **6.66%** as the Pyramid's capstone is to its entirety, we would get a mountain of stone over 2.4 miles high and when we add its height and base measurements we would get 29,186 ft, a difference of only 157 feet from the current height of Everest.

# Plan of the Third Temple

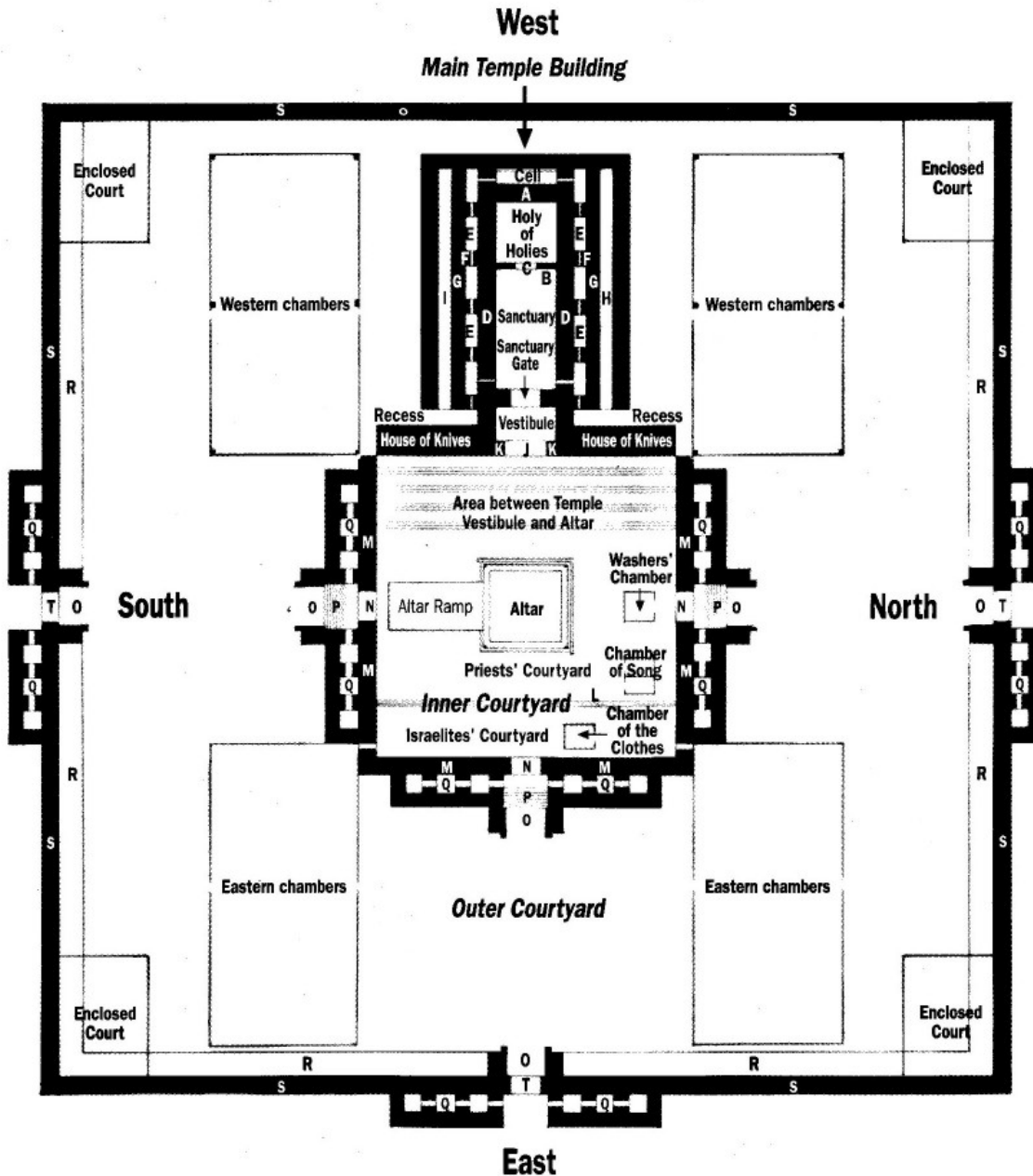

## Key:

- |                                        |                                |
|----------------------------------------|--------------------------------|
| A: Back wall of Holy of Holies         | K: Vestibule Wall              |
| B: Wall of Holy of Holies              | L: Platform and Duchan         |
| C: Entrance to Holy of Holie           | M: Inner Courtyard Wall        |
| D: Sanctuary wall                      | N: Inner Courtyard Gate        |
| E: Cells at the sides of the Sanctuary | O: Vestibule of the Gate       |
| F: Cell wall                           | P: Eight steps                 |
| G: Exterior wall of cells              | Q: Cells by the gate           |
| H: Winding staircase                   | R: Elevated paved gallery      |
| I: Rainwater spout                     | S: Wall of the Outer Courtyard |
| J: Vestibule Entrance                  | T: Gate of the Outer Courtyard |

After we orient the Holy of Holies, our next step is to site the Central Altar within the Future Holy Temple because everything spreads out symmetrically and concentrically from there. We already know its measurements of **32 x 32** cubits from the Ramchal, so it is just referential that the base of the capstone measures **32.0' x 32.0'**. Both sets of information exist independently,



as did the GPS elevation readings of the Temple Mount and the tape measure readings of the Pyramid first taken thousands of years apart.

We saw how the height of the pyramid, **481.25** feet, and its base, **756.25** feet, taken together gave us an interesting equation based on the **27.5"** cubit with a result of **45** cubits. If we instead subtract (**756.25' - 481.25'**) we get a difference of exactly **275.00**, aligning it with the height of the **100-cubit** Holy of Holies Temple Building: **2750"**. That difference, which equates to (**275' x 12"**) = **3300** inches, aligns it in turn to the **330-cubit** base of the pyramid.

An interesting dynamic of the Pyramid happens because the base of the Pyramid (**756.25'**) is already **27.5<sup>2</sup>**, when we use the base in inches as **9075"** and multiple it by **12** and then take its square root, we wind up with **330**. Perhaps more important is that the difference between the Pyramid's base and height, **3300"** less the height of the Temple Building that houses the Holy of Holies is (**3300" - 2750"**) = **550" = 20** cubits. The value **20** cubits is the width and breadth of the Holy of Holies. It is also the difference in the height of the Future Holy Temple and the First Holy Temple that was **120** cubits high because it needed an additional upper floor that the Future Holy Temple does not. As the cubit used in the earlier Temple was smaller than that of the secret cubit and "the height of the Third Temple is one hundred cubits, these being the hundred of *keter*, [the height of the Future Holy Temple in feet] is far greater than the entire hundred and twenty cubits of height of the First Temple," as explained by the Ramchal.

Why are there **12** inches in a foot and why is this proportion incorporated in the Great Pyramid long before its use in England. Why were there **12** tribes in Israel, analogous to but not corresponding to the **12** sons of Jacob that were part of the **70** family members that began the **210** years of Egyptian exile. Why were those **12** tribes arranged in camps along a **4-sided** square aligned to the **4** directions? Why was the 600,000-man encampment arranged in **3** tiers or concentric squares?

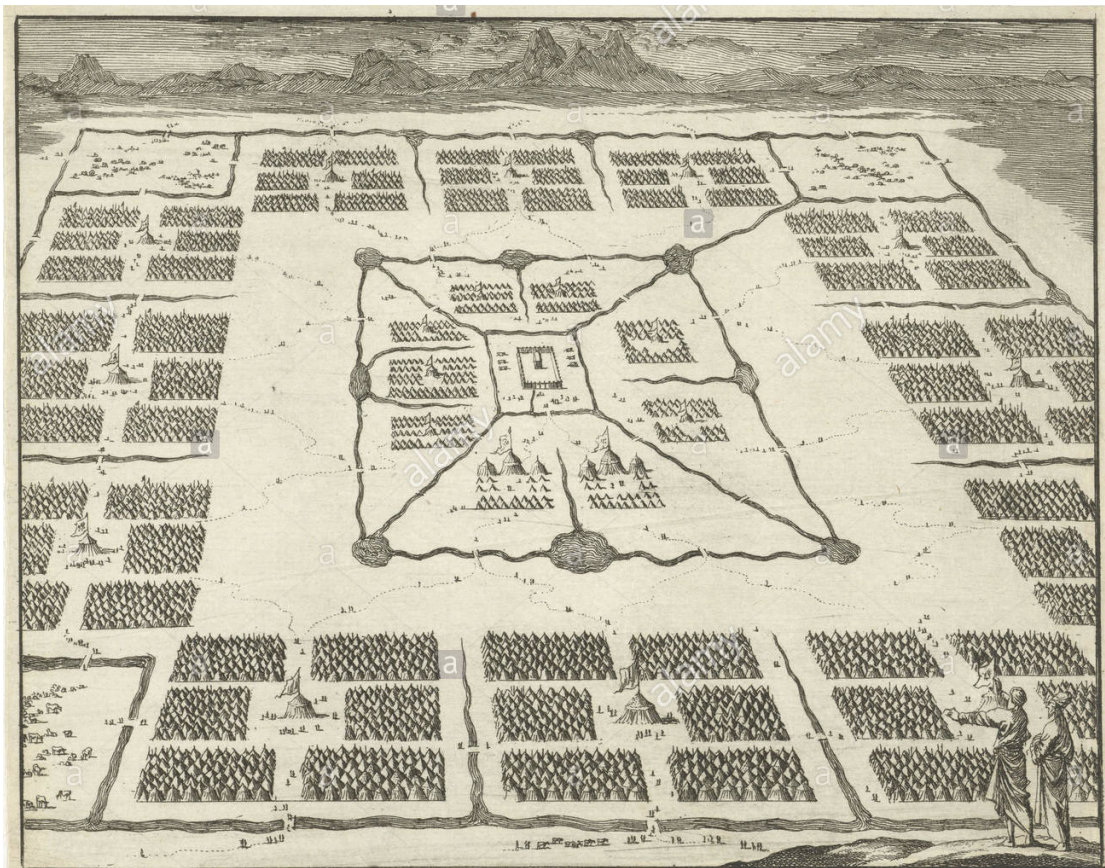





The measure from the center of the Central **32 x 32** cubit Altar to the edge of the Outer Courtyard and the back of the Holy of Holies is **156** cubits, the numerical value of Zion (????), which is the nexus point that links our dimension with hyperspace. In feet, it is within inches of **358**, the numerical value of *Moshiach*. Since the Holy of Holies is **20 x 20** cubits and the wall behind it is **6** cubits deep there are 140 cubits from the center of the Holy of Holies to the center of the Central Altar. Those 140 cubits are equivalent to the **320.833** feet, and thus analogous to the **32.0833** feet of the Capstone's base. And the distance from the center of the Holy of Holies to the Eastern edge of the Outer Courtyard is thus **296** cubits, analogous to the numerical value of the Torah's 7<sup>th</sup> word, Earth (????). The nexus between Heaven and Earth.

### **We Must Understand the 112 Triplets**

No one can walk from the center of the Altar to the back of the Holy of Holies. They would have to begin at the edge of the Altar, **16** cubits from the center and stop at the **2**-cubit thick gate of **42**. Given the Holy of Holies is **20** cubits deep, its rear wall is **6** cubits deep, and the gate wall is **2** cubits, the distance from edge of the Altar to the Gate of **42** is  $(156 - 16 - 28) = 112$ , matching cubit for cubit the **112** Triplets of the **4** Essential Elements.

The following is very simplified and there is deep wisdom here. According to the Ramchal, two sets of lights comprised of 3 Names each descend and merge (???? ???? ???? ) and (???? ???? ???? ) as “male” and “female” energy. When they meet the 3 Names (???? ???? ???? ) the gates open. We will expand on this in a later article. For now, we see that the **9** combined Names equal **336** as in the **336** letters in the **112** Triplets.

The full value of the Inner courtyard with its surrounding **6** cubit thick walls in both East-West and North-South is **112** cubits making the knowledge of the **112** Triplets critical for building the Third Temple.

We already saw the **112**-cubit measure incorporated on the West side in the walk from the Altar to the Gate of **42**. Now too, the full value of the North, South, and East sides of the Outer courtyard with its surrounding **6** cubit thick walls is also **112** cubits making the knowledge of the **112** Triplets critical for all aspects of the building the Third Temple. In case you were wondering, **112** Cubits is 3080” or **256.666’**.

### **Water Flows Through the Holy Temple**

If we already know the dimensions of the Future Holy Temple and now know where to site it,

---

why do we need to break them down? We are not speaking of bricks and mortar. We are talking about energy and need to understand what it connects to. The reason for building the Future Holy Temple is to connect with the Creator through *Binah*/hyperspace and *Binah* is Understanding. In order to make the connections we must have intention and in order to have intention we must have knowledge and Understanding of that Knowledge.



We have written in the past about the connections between the **3** temperature scales and the dimensions of the **3** rings of the Future Holy Temple. As we have explained previously, most energetic studies in Kabbalah are based on **3**: as we find with the **3**-iterated Name expansions; the **3**-dimensional boundaries of physicality; the **3**-pronged locked dances of electricity (Positive-Neutral-Negative poles), the Atom (Proton-Neutron-Electron), and that of the Solar System (Earth-Moon-Sun); and the **3**-column system of the Tree-of-Life. The **4<sup>th</sup>** energetic element always takes us into the realm of hyperspace.

The design of the Temple starts at the center of the **3** concentric rings, where the square Altar measures **32** cubits a side, matching the freezing point of water, **32° F**. The Inner Courtyard that circumscribes the Altar measures **100** cubits per side, equating to the boiling point of water, **100° C**. The Outer Courtyard that circumscribes the Inner Courtyard is **312** cubits from North to South and 317 cubits from West to East, with the extra 5 cubits to create a buffer behind the Holy of Holies. The difference between the measures of the two Courtyards is **212** cubits, equating to the boiling point of water, **212° F**.



In the spiritual realms such as *Binah*/hyperspace spiritual distance is measure in similarity of form, which means that neither units of measure, nor the scale that is being used to measure something, nor what that something is, even time is relevant, only the number. This is why when people's consciousness try to awaken they will start seeing trails of the same numbers appearing everywhere. It is not as certain pseudo-scientists would tell you because you are just focusing on that number to exclusion of all else.

The absolute freezing point, or absolute zero is **-273° C** or **0° K**. The distance **273** feet equals

---

**625.625** inches. Can this measure **273** that is built into our solar system every which way also be an obvious reference to  $625 \times 625 = 625^2$ , which equals the precise number of the words, verses, and letters in the Torah?

The blatant connection of the dimensions of the Future Holy Temple to the temperature-phase dynamic of water with water freezing at **32° F** and boiling at **100° C** and **212° F** is readily apparent. The zero point would be located at the center of the Altar, referring simultaneously to the freezing point of water **0° C** and absolute zero, **0° K**.

We will posit at this point that the elevation at the center of the base of the Alter is **2428'** or **20'** less that the Holy of Holies at **2448'** feet since we know that the elevations at the Mount varies and are 10-20 feet lower towards to North, South and East, that the **20 cu x 20 cu** Holy of Holies would be at the highest point within the Temple walls; that **20** signifies *keter*, or the highest level; that the internet has already adopted **2428'** as the height of Temple Mount and that  $(2428' + 273') = 2701$ , the value of the Torah's first verse. So once again, we have the all-important number of our Solar System, **273**, tied to the Torah and emanating from the exact center of the Third Holy Temple, the place of absolute zero, **0° K**. and **-273° C**, and water's freezing point, **0° C** and **273 K**. From the Torah's first verse (**2701**) to all **390,625** words, verses, and letters, contained within a single point.

The Central Altar measures **32** cubits by **32** cubits or  $2^5 \times 2^5$ , meaning its base area is  $2^{10}$  or **1024** aligning itself once again with the Torah through the  $2^{10}$  or **1024** word values in the Torah.

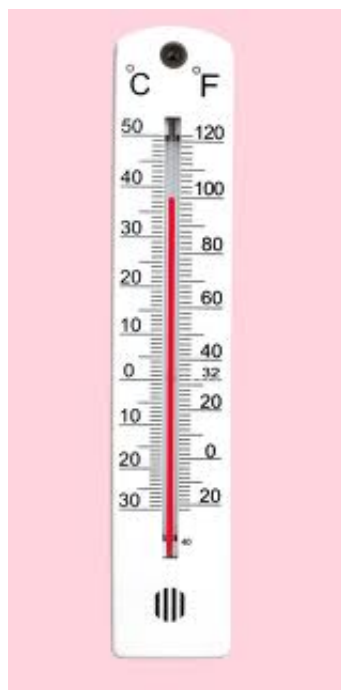

Given this schematic, the Altar where the sacrificial fires are burned would be the Freezing Zone **0° - 32°**. The **100** cubits of the Inner Courtyard less the **32** cubits of the Altar, or **68** cubits, would be the Living Zone, corresponding to *Chaim* (life) of numerical value **68**, and the Boiling Zone of the Outer Courtyard would correspond to **100°** and **212°** from the **100** cubit inner wall to the **312** cubit outer wall. The **4<sup>th</sup>** phase of water so necessary for life would correspond to the edge of the Altar and the Inner Courtyard, but that is a whole other topic of discussion.

While the surface temperature of the Sun is **5778° K**, the moon's is **100° K** at its equator, connecting it to the **100**-cubit Inner Courtyard. It also makes the moon's surface temperature **-173° C**, linking it with the small gematria of the **42**-Letter Name, Moses' **173** Keys to *Binah*.



---

Whether the surface Temperature of the rest of the planets in our Solar System are integrated in this intelligent design is open to debate. For example, the surface temperature of Mars is **210° K** and that of the two neighbors Saturn (**134° K**) and Uranus (**76° K**) together is also **210° K** and that of Jupiter is **165° K** or **330/2**, alluding to both the height and base of the Pyramid.

Then, while the surface temperature of Pluto being **50° K** might connect to the **50** Gates of *Binah* and the **50**-cubit height of the Gates in the Holy Temple, when coupled with the **72° K** surface Temperature of its neighbor Neptune, they align with the words in two central paragraphs of the *Shema*.

Since the recent cycle of global warming has heated up Earth to **288° K**, the combined surface temperatures of the four (**4**) planets flanking Jupiter is (**210° + 288° + 210°**) = **708° K** with Jupiter being the **5<sup>th</sup>** planet from the Sun and **5708** being the year Israel became a nation, and **708** being the value of the Upper **42**-letter Name of (????) incorporated into the 15 Triplets of the *Shema*.

Is it possible that whoever Created our Solar System also gave the plans of the Future Holy Temple to the Ramchal, and sited it for Abraham, David, Solomon and us?



Energy is likened to water and the Holy Temple is all about the flow of energy. From the sea of *Binah* and the river of *Binah* into the **4** rivers that serve physicality. From the Holy of Holies into the Altar and outward through the **4** sides/directions of the courtyards. The life-giving spiritual energy (*Shefa*) does not freeze, nor boil but it does pass through phases as it flows through the Temple structures and outward into the universe.

### Another Primordial Constant

At the pinnacle of our connection between our world and the upper world-to-come, also known as *Binah*/hyperspace are the thrice expanded two Names *Ehyeh* (????) and the unpronounceable (????) that we explored in our last article. We saw how those expanded components of *Ehyeh* (????), (**506 + 110 + 1818**) = **2434**. We also saw how the expanded components of the Tetragrammaton (????) equaled **708**, as in the surface temperature surrounding the 5<sup>th</sup> planet and as in the year **5708** when Israel became a nation **70** years ago, and moreover, how together (**2434 + 708**) equaled **3142**, the same as the small gematria of “**I Am That I Am** (????????????????).”

**אהיה**  
**אלף-הי-יוד-הי**  
**אלף-למד-פא-הי-יוד-יוד-ויו-דלת-הי-יוד**  
**יהוה**  
**יוד ה' ויו ה'**  
**יוד ויו דלת ה' יוד ויו יוד ויו ה' יוד**

Breaking the two Names down, we see that there are 20 *Vavs*(?), 12 *Heis*(?), 24 *Yuds*(?) and 4 *Alefs*(?), or the 60 letters that comprise the two Names *Ehyeh* (????) and the Tetragrammaton (????). Collectively those 60 letters total **424**, the value of *Moshiach Ben David*. This in and of itself tells us how important these Names are to the critical point of reaching *Binah*/hyperspace, but there is another secret concealed in the 6 lines of the two expanded Names. Given that the two sets of 3 iterations total **3142** and the higher components of them total **424**, the rest of the letters  $(3142-424) = 2718$ , as in the all-important Napier's Constant (**2.718...**).

Napier's constant, also known as Euler's Number *e*, is a natural limit found throughout and integral to our base **10** mathematics and critical to both mathematics and physics. Euler's Number *e* is the unique number whose natural logarithm is equal to One(1). It is now the fourth primordial constant we have found baked into the Names of G-d, the **4** Essential Elements known as the **112** Triplets, and the Torah's design.

We could almost say that the combined **3** iterations of *Ehyeh* (????) and the Tetragrammaton (????) equate to *Moshiach Ben David* and One(1).

The **5** letters that comprise the **2718** gematria total associated with Euler's constant spell out *Lamed*(???) totaling **238**, and *Pat* (??), **2480**. The total **238** is the same value as the Matriarch Rachel and approximately  $1/42$  or **.238095**. While the total **2480** matches the total for the **5** Names of the **5** Books of the Torah, etc, the word *Pat* (??) is used only once in the Torah, as the "morsel" of bread that the overly generous Abraham gave to the **3** angels that visited him, indicating that he knew they were angels and thus did not eat. The value **2480** is also derivative from 3 of the 4 Essential Elements that comprise **40** of the **112** Triplets in that  $10^4 - (1118 + 2701 + 3701) = 2480$ .

The **4** letters *Vav* (?), *Hei* (?), *Yuds*(?) and *Alef* (?) that total **424**, have numerical or energetic values that add up to **22**, as in the **22** letters in the *Alef-bet*. The other **5** letters that totaled **2718** have a value of 554, so all 9 letters of the Holy Names equal **576** or  $24^2$ , matching the volume of a *mikveh* (**40** seah or **576** eggs), and the inner **24 x 24**-cubit space on top of the Central Altar of the Temple where the wood pile is kept. The energy keeps coming back to *Moshiach Ben David* in that  $(1000 - 576) = 424$ , so the most central design element within the Holy Temple, the inner **24 x 24**-cubit space on top of the Central Altar connects to the energy and process of

---

cleansing, the two powerful expanded Holy Names and *Moshiach Ben David*.

## The 3 Rings of the Third (3<sup>rd</sup>) Holy Temple

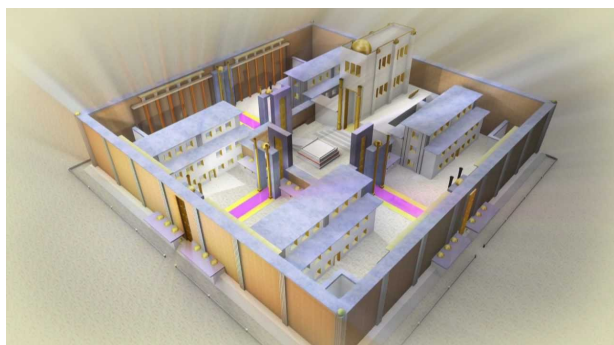

The Future Holy Temple, or Third Holy Temple, is designed with and divided into 4-sided squares that connect us to *Binah* hyperspace at the end of the 4<sup>th</sup> exile. The 3 concentric rings are designed to channel that energy (*Shefa*) to the 3-dimensional world of physicality. The blueprints of the Future Holy Temple are integrated with the schematics of the Torah, the Names of G-d, and the 4 Essential Elements. If we sum up the 3 components of the Tetragrammaton (????) within the 112 Triplets of the 4 Essential Elements, we get 12 *Yuds*(?), 24 *Heis*(?) and 12 *Vavs*(?) equaling a total value of 312, the measure of the width of the 312-cubit Outer Courtyard that surrounds the Temple buildings, the 3<sup>rd</sup> ring. Of course, adding (12 + 24 + 12) or 48 to 312 gives us the 360° of a circle. The connections to four (4) raise us above the realm and the bonds of physicality. The allusion to the circle of the Outer Courtyard is illustrative of how the energy expands outward to give life to the universe.

It is not coincidence that within the 112 Triplets, the 312 total, the 312 cubit width of the Outer Courtyard, we find 12 *Yuds*(?), 24 *Heis*(?) and 12 *Vavs*(?) in simple and obvious multiples of 12. It is structural.

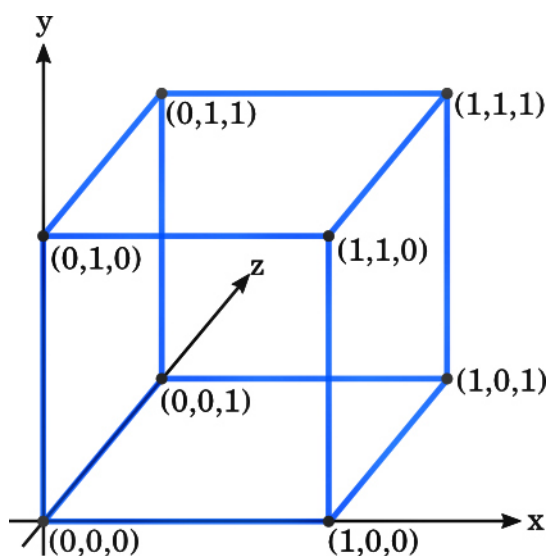

The Zohar points out that there are 12 edges to a cube and given 6 directions in space energy expands in 12 directions as space unfolds. The Holy Temple may be built in physical space, but it matches up with a hyperspace version that has no limitations. Like our consciousness that links up above, so too do the stones of the Third Temple.

It is also not a coincidence that within the 112 Triplets and the 312 cubit design of the Outer



Courtyard we find these **12 Yuds(?)**, **24 Heis(?)** and **12 Vavs(?)** combine together to form exactly **12 Tetragrammaton (????)**, or that there are exactly **12** permutations of the Tetragrammaton (????) totaling **312**. Abraham Avinu explained that these **12** permutations connect to the **12** months of the year. While the **12** months are split into **4** seasons, as are the **4** walls of the Outer Courtyard, the ancient Kabbalists associate these **12** permutations to the **12** Tribes and some of the kabbalists assign them to the **4** square sides and **4** directions according to how the Torah lays out their encampments around the Tabernacle. In such a manner with **3** permuted Names in each direction of the Outer Courtyard there would be **12** letters associated with the Tetragrammaton (????) in each of those **4** directions.

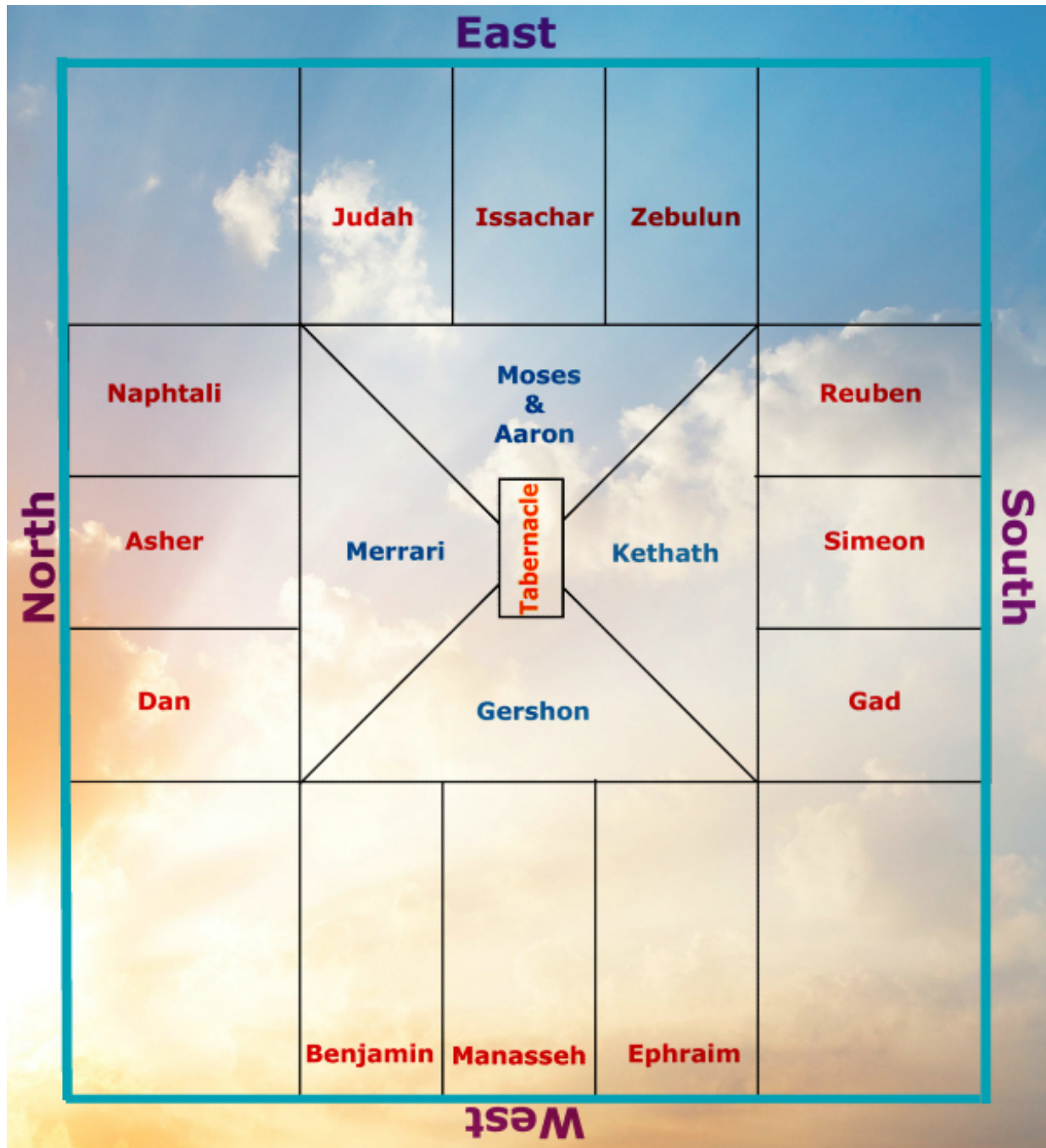

### Five Final Letters

The two dimensions of the Outer Courtyard **312** by **317** cubits give us net dimensions of

**280** and **285** when the **32** by **32**-cubit Central Altar is separated out, aligning with the sum of the **5** final letters (?????). To the Kabbalists, these **5** special final letters have always been associated with the future end-of-days and total **280** and **285** with the *kolel*. It was Rav Brandwein who once explained to me that the final letters in the Torah point to the future.

### USA and the Future Holy Temple

When we take the perimeter of the **3** rings together, adding them up as  $(32 \times 4) + (100 \times 4) + (312 \times 4)$  we get  $(128 + 400 + 1248) = 1776$  cubits. This is not only  $(42^2 + 12 \text{ sides})$ , but the year the United States of America became a nation in **1776 CE**. The perimeter value of the **3** rings, **1776** cubits, is also equivalent to the value of the Hebrew *Alef-bet* including the **5** final letters plus 1:  $(1495 + 280 + 1) = 1776$ , one cubit for each energetic value of the **27** ( $3^3$ ) letters. Given that the dates, **2448 HC**, **5708 HC**, **5778 HC** and **1776 CE** are baked into the Torah and the Third Temple is it a stretch to assume the formation of the **13** Colonies into the (eventual) **50** States of the USA was part of a designed plan? *Hashem Echad*; **50** Gates of *Binah*.

Is it a coincidence that after **242** years in the period of its **45<sup>th</sup>** President the United States has moved its embassy to Jerusalem in the shadow of the Temple?

The above equation of the perimeter can be broken down into  $(2^7 + 20^2 + 10^3 + 248) = 1776$  with the  $(10^3 + 248)$  Outer Ring component equivalent to the letters and words in the *Shema* and the Inner Courtyard component equal to the area of the Holy of Holies and *Keter*<sup>2</sup>. It is similar to how the Torah described the life of Sarah: **7** and **20** and **100** years.



The fourth **4<sup>th</sup>** verse of the Torah states, “And God saw that the light was good; and God divided the light from the darkness (????????? ?????????? ??? ?????? ????? ?????????????? ?????????? ?????? ??????? ??????????????)” Its numerical value is **1776**. Moreover, we are reminded here that “The Light (???????)” has a numerical value of **212** as in the difference between the two Courtyards (**312 – 100**). Who saw that The Light was good? Yes, the illuminati were also founded in **1776**, but Who divided The Light from the darkness?

### Three Temples; Four Exiles

Another example of time and time periods as measured in years being incorporated into the Creator’s plans for the Temples is the **832**-year period that the first two Holy Temples stood (**422** and **410** respectively), representing exactly **1/4** of the time period between the giving of the Torah at Sinai in **2448 HC** and **5778 HC**.

---

The Third Holy Temple's Central Altar has a base of **32** cubits squared and rises **10** cubits to the priest pathway, a square of **26** cubits per side. The connection between **26** and the Tetragrammaton (????) and between **32** and the **32** elements (**22** Pathways and **10** *sefirot*/dimensions) of the Tree of life, etc. has been firmly established, so the incorporation of these key measurements is not surprising, yet **26 x 32** equals **832**.

This **832**-year time period also stretches from the construction of the First Holy Temple in 2928 HC to 3760 HC, the pivotal year "0" chosen for the Gregorian calendar, meaning that the First Holy Temple was built in **-832 CE**. It is also the **832** years from the beginning in the Flood in 1656 to Moses' death in 2488. Moreover, the (**3760- 832**), or **2928**-year, period represents the number of years that we have not had the Temple from the Covenant of Halves in **2018 CE** to **5778** (today).

Like the 3 references for the counting of the Israelite men and the **3** Patriarchs, the Torah gives **3** time periods for the Egyptian exile—**210**, **400** and **430** years long—all embedded with meaning. The earliest date takes us back to (**2448 HC – 430**), or **2018 HC** when Abraham was still in Canaan, **70** years after his birth in **1948 HC**, an event analogous to the birth of Israel as a modern nation in **1948 CE**, **70** years ago. This would mean that our exile began **3760** years ago.

The second period (**2448 HC – 400**), or **2048 HC** began when Isaac was born, and the 3<sup>rd</sup> period (**2448 HC – 210**), or **2238 HC** began when Joseph and then Jacob entered Egypt. The number of years we have not had the Temple since Adam is (**5778 –**



**832**) = **4946** years. [As advanced and planned intelligence would have it](#), the square root of **4946** = **70.32**, a wonderfully graphic link between **70** and **32**. The number **70** represents the **70** nations that the Jews have been dispersed to in the **4** exiles; and the **70**-year period of the Babylonian exile between the First and Second Temple; and the Year of the destruction of both the Second Temple in **70 CE** and the First Temple in **422 BCE** with **422** being the gematria of the Hebrew word for **70**. Moreover, **422** years is the time period for Second Holy Temple. The number **32** is the Central Altar in all **3** Temples and most critical is that there are exactly **7032** letter *Dalets* (?) in the Torah, and the letter *dalet* (?) is the **4<sup>th</sup>** letter in the Hebrew alphabet with the numerical value **4**, as in  $\frac{1}{4}$  of the **3330** year time period.

Furthermore, **70** and **4** are interrelated through the two enlarged letters in the first verse of the Shema and its 15 Triplets, *Ayin* (?) and *Dalet* (?)

You may have noticed how the number **70** comes up often in our key number, besides just the obvious and all-important **70** periods (i.e. **5708 HC**, **708**, **2701**, **3701**) and both the Zohar and the Ramchal explains that “the lower lights through with the world [physicality] is actually conducted are seventy [**10** lights for each of the **7** *sefirot*]. And as we wrote about previously,



---

the natural log of **70**, or  **$\ln(70) = 4.248\ 495$** . These are the same natural logs based on the all-important Napier's Constant (**2.718...**), which we saw incorporated in the 3 iterations of the two Names that totaled **3142** and whose higher components totaled **424**, leaving **2718** for the rest of the **9** letters.

Moreover, the sum of the logarithms of the integers from **1** to **70** is **100.078**, corresponding the **100** cubit measure of the Inner Courtyard.

It takes a great deal of planning to work the primordial constants into all these equations and dates, and/or to work all the future dates into the primordial constants. There is probably a reason!

## Mercy and Judgement

Those two Central Altar dimensions (**26** and **32**) are also found in the center of a series we highlighted in a prior article. It is a sequence of **7** numbers (**22, 23, 26, 32, 42, 57, and 78**) incorporated into the Torah and that are based on a progression of the first **6** triangular numbers. Triangular numbers represent the sum of all the positive integers through a particular number  $n$ . The difference sequentially between the numbers (i.e.  $23-22 = 1$ ) is **1, 3, 6, 10, 15, and 21**, which represent the sum of integers up to the numbers 1, 2, 3, 4, 5, and 6 respectively. This system of conserving energy and that energy is never lost has also been firmly established as integral to the Torah's design.

One critical example of this integration is found in number of the occurrences in the Torah of the *Yuds* (?), *Heis* (?) and *Vavs* (?) components of the Tetragrammaton (????). They total exactly **90,100**, which is the sum of all the integers from 1 - **424**, the numerical value of *Moshiach Ben David*. As for dates, **5778** is the sum of the integers from 1 - 107, the **28<sup>th</sup>** prime number. In essence, since this sequence (**22, 23, 26, 32, 42, 57, and 78**) begins with the number **22**, it represents cumulatively the combined energy of the numbers 1 through **6** added to the number **22**, possibly analogous to the **22** letters of the Hebrew Alphabet. These **6** cumulative triangular energies (**1, 3, 6, 10, 15, and 21**), when seen as the ordinal values of Hebrew letters, they represent the **6** Hebrew letters (?,?,?,?,?) respectively. Together the **6** letters have the complete gematria value of **424** when the *kolel* of **6** is subtracted. The sum of the numerical values of the individual letters *Yud* (?), *Hei* (?) and *Vav* (?) is **21**, like the upper limit in the previous series. When we multiply the values of the *Yud* (?), *Hei* (?) and *Vav* (?) together ( $10 \times 5 \times 6$ ) we get **300**, and when we spread the light by squaring, as instructed by R'Chaim Vittal of blessed memory, we get **90,000**. Then adding the **100**, representing *Keter* for completion, and as in the **100<sup>th</sup>** prime number, **541**, the value of Israel (?????), we get **90,100**. Moreover, the squares of the first two letters in Israel (?????) also equal **90,100**, while the last two equal **901**. As the Ramchal points out **90** is associated with *Chochma* (Wisdom) in



---

which Solomon built the First Temple, and **100** with *Keter* in which the Third Temple will be built. Suffice to say, the Creator has designed the Torah to bring us *Moshiach Ben David* in the right moment and He gave us these powerful Names of His to help support and keep us connected to that energy all along the way.

We just saw how the dimensions of the Outer Courtyard less the Central Altar equaled **280**, the value of the **5** powerful final letters (?????) associated with severe judgment and the end of days, so yet another integration is laid visible to us through those sequential Torah values (**22**, **23**, **26**, **32**, **42**, **57**, and **78**) that also sum to **280**. We have known about this since the Covenant of Halves that the Creator made with Abraham in **2018 HC** and ever since Abraham wrote about the **22** building blocks, the Tree-of-life, and the systems of how to read the energy in the letters and numbers **3760** years ago.

When we add the prime numbers associated with the (**22<sup>nd</sup>**, **23<sup>rd</sup>**, **26<sup>th</sup>**, **32<sup>nd</sup>**, **42<sup>nd</sup>**, **57<sup>th</sup>**, and **78<sup>th</sup>**) sequence (79, 83, 101, 131, 181, 269 and 397) respectively, along with their *kolel*, they sum to **1248**, as in the **1248** cubit sum of the **3** Ring perimeters, the design of the *Shema*, and as in *Binah* (**1000**) and Abraham (**248**).

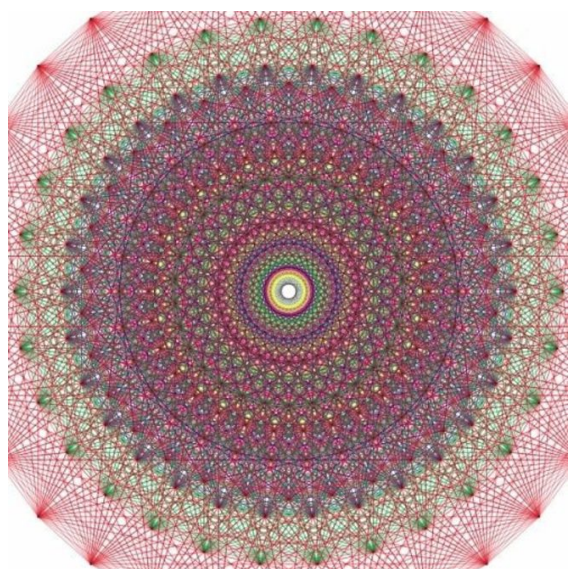

The 3<sup>rd</sup> Ring of **312** cubits has the **32**-cubit Altar in its center, just as the sequence (22, 23, 26, **32**, 42, 57, and 78), and while (**312 – 32**) was **280**, the difference (**280 – 32**) = **248**. Does **248** refer to the archetype mountain of mercy represented by Abraham? Is the energy coming off the Central Altar an admixture of judgement represented by the **5** powerful final letters (?????) and **280** and mercy by **248**? We must not only build the Third Temple but Understand it.

### **3 Accounts 3330 Years Ago**

The last two portions of the 3<sup>rd</sup> Book of the Torah, *Behar-Bechuchotai*, have **57** and **78** verses respectively, and are most often read together. The last two portions of the 4<sup>th</sup> Book of the Torah, Numbers—also most often read together—correspond to the end of the 4<sup>th</sup> exile. *Matot* and *Massei* and they describe the **42** journeys of the Israelites and then the final counting of them as they prepare to enter Israel. That same Book of Numbers begins, right after the **57-78** verse portions, with the Israelites being counted in *Bamidbar* 1:1 – **4:20**. The total count was **603,550**, and though the Torah tells us that all but 2 died off somehow and that some of the **12** tribes gained members and some lost them, the second counting shows us that their ranks

were back up to **601,730**, only **1820** men less than they began their journeys. What stands out immediately are the **1730** men and the **173** keys that the Zohar tells us Moses was given to access *Binah*/hyperspace, alluding to the **42**-Letter Name whose small gematria is **173**. Next, we notice that **3550** is **1775** x **2** and we know that Moses was falsely accused by the *Erev Rav*, the Mixed Multitudes, of stealing **1775** shekels from the collection for the *Mishkan*. Sound familiar? What he was falsely accused of was stealing the **22** Letters of the Hebrew Alphabet plus the **5** final letters since these total respectively (**1495** and **280**), or **1775**. The next thing that comes to light is that the extra **3550** and **1730** together equal **5280**, not only another allusion to the **5** final letters totaling **280**, but also the **5280** feet in the mile. Moreover, not only do **1730** and **3550** add up to **5280** but their ratio is very close to the kabbalistic  $1/3$  and  $2/3$  proportion. We have previously discussed their difference (**3550** – **1730**) of **1820** and just want to reiterate that it is purposefully a product of **70** years x **26**, the gematria of the Tetragrammaton (????). The **42** journeys are delineated over 49 verses, much like the annual counting of the Omer, and like *Lag B'omer*, the **33<sup>rd</sup>** day of the Omer, they are counted in the **33<sup>rd</sup>** chapter of *Bamidbar*. In verses 8 and 9, we find the only numbers mentioned in the entire **42** journeys: "...**3** days...**12** springs of water...**70** palm trees..." Besides allusions to **3** Temples, **12** founts of energy and **70** year time periods and lights we know from the Arizal that when we take the **600,000** souls at Sinai, and divide them by **70** (Jacob's family members who entered Egypt), and by **12** (the **12** tribes/sons) and by **3** (Patriarchs) we get exactly  $1/42$ . But there is more to the **600,000**. Thanks to the existence of Napier's constant (**2.718...**) we have logarithms, and thanks to logarithms we have yet another clue to the intentions and design of the Creator of our universe. The log of **600,000**, the round number given in the Torah for the Israelite men at Mt Sinai, is **5.778**. The log of **601,730**, the precise second census number given in the Torah for the Israelite men, is **5.779**, and the log of **603,550**, the precise first census number given in the Torah for the Israelite men, is **5.780**. We understand some of the technology embedded in the two censuses that we previously studied and now, knowing that the guiding primordial constant of logarithms was itself embedded in the Names of the Creator, we can grasp that there was an even deeper purpose of giving us **3** different numbers for the same reference. Now that the information is relevant and critical to us, we can see why is

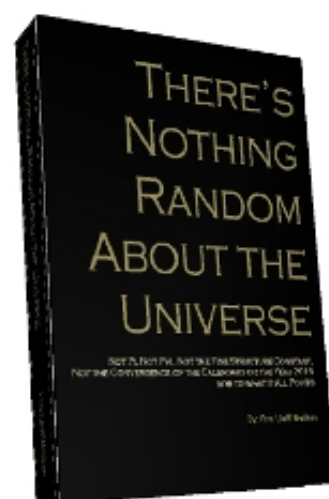

was concealed until a time when we could decipher it. Now we can grasp that the **3** references were alluding to dates. The idealized **600,000** relates to the idealized year **5778** HC about when the final process began, **70** years after Israel became a nation, and [found 3 times in the first 1000 \(Binah/Alef\) digits in Pi](#). The first census of **603,550** perhaps relates to the date **5780** when the **3**-year period is to conclude. And the second census of **601,730** relates to the date **5779** when it will be revealed, corresponding to the **3** times its counterpart, **2019** is found in

---

those same first **1000** digits of Pi.

We will go deeper into the dimensions of the Future Holy Temple, but for now, the **600,000** men begin with the number **6** for the same reason the Temple walls are **6** cubits deep and the **27.5**” cubits are **6** handbreadths. The number **6** is the number of *Vav(?)*, a connector symbolic of the **6** bundled dimensions of *Zeir Anpin* that connect *Binah* with our world, *Malchut*, without being a party to either. As a prefix it means “and” and about **60%**

of the verses in the Torah begin with *Vav(?)*. The walls of the Holy Temple are not separators; they are connectors. They delineate the different forms of energy in the 3 rings and within each space within the Temple and help transfer and transform it to the next. Like the energy of Jacob that needed to be passed down through his **12** sons/Tribes the two walls of the courtyards collectively are **12** cubits thick. Most importantly, this is analogous to the two *Vavs(??)* transferring the energy between the two *Yuds(? ?)* of the *Alef(?)*.



---

The **32 x 32**-cubit Central Altar is solid. When the **20 x 20** cubit Holy of Holies is superimposed, the physical difference is **12** cubits per side, matching the Courtyard walls.

Time and space are coming together in the design of the Future Holy Temple, a design planned in a dimension we cannot comprehend, yet in dimensions we have the tools to Understand.

Those dimensions tell us the Future is Now and that this is the time for the Third Holy Temple and the end of the **4<sup>th</sup>** exile. The Tower of Babel incident in **1776 HC** used advanced ancient technology and caused the One language to scatter into the **70** of the exile. Recent modern technology that began 18 years ago has reunited those **70** languages. There are two ways to connect: silicon and numbers derived from the minds of men, or stones and numbers given to us from the Creator. One way cedes our consciousness to other men and their machines; the other liberates it. Only one way allows our consciousness to actually elevate. There is only one happy ending.

“And God saw that the light was good; and God divided the light from the darkness.”

For anyone that has not been following this series from its inception, you can find the [entire work here](#).

Shabbat Shalom,

Ezra